

# TRACKGRIP®

TRACTION - STABILITY - SAFETY 

▶ TrackGrip makes a range of excavator and bulldozer shoe cleats designed to enhance traction on difficult terrain.

## Technical Data: Mighty Grip Cleats For Excavators

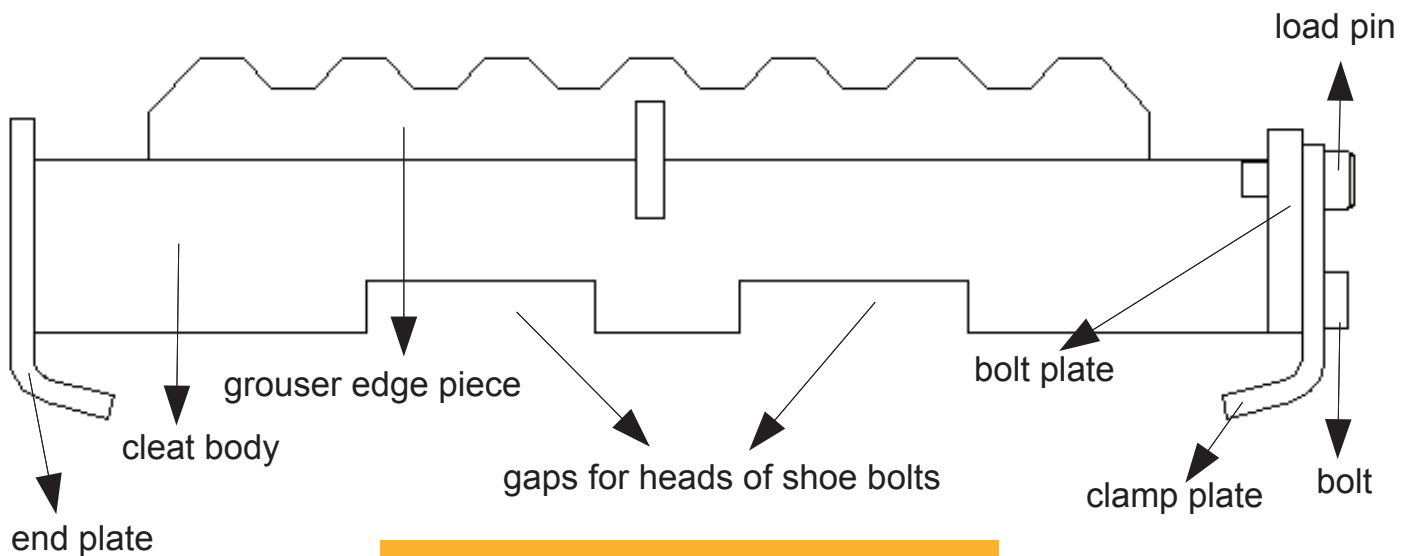

**Mighty Grip Front View**

**Cleat is designed to fit shoes 450mm - 950mm wide, See specifications table for application details.**



# Schematic Cross-Section of Mounted Cleat

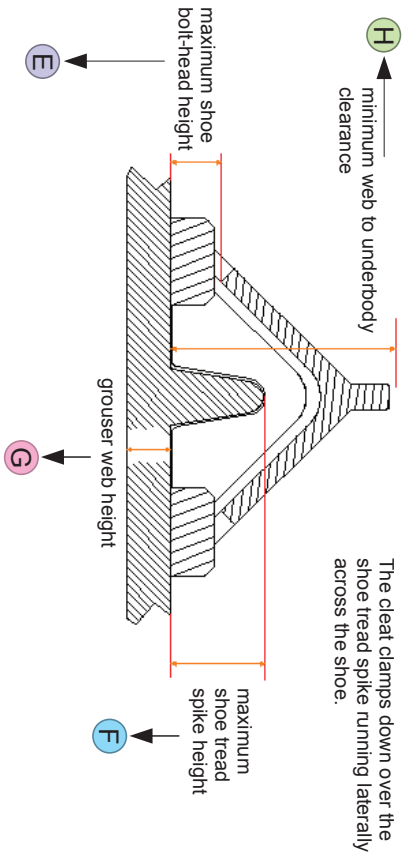

# Excavator Shoe Plan

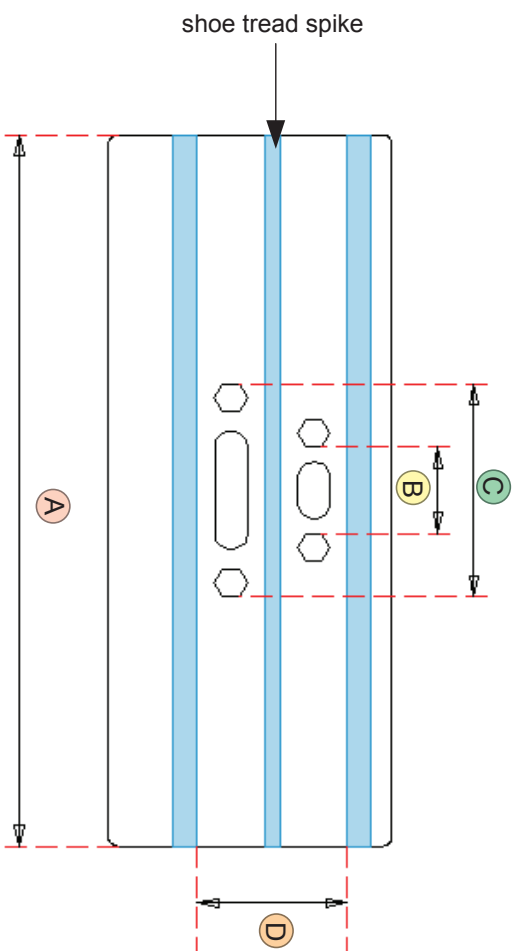

NOTE	A	B	C	D	E	F	G <sup>Min</sup>	G <sup>Max</sup>	H	Min	Max		MS Angle	Thickness	Matl	Thickness	Matl	Square	Thickness	Matl	deg F	deg C	Soft	Med	Hard
Excavator Shoe Width	mm	mm	mm	mm	mm	mm	mm	mm	mm	ton	ton			mm		mm		mm	mm						
Minimum Shoe Bolt Head Spacing	450	52	208	95	18	26	4	8	100	-	10	M12 x 50	75 x 75 x 6	10	A573+	8	MS	12	8	MS	14	14	X	X	X
Maximum Shoe Bolt Head Span	500	52	208	95	18	27	6	8	105	10	16	M16 x 50	80 x 80 x 8	10	A573+	10	MS	14	10	MS	14	14	X	X	X
Minmum Grouser Clamp-On Length	600	52	208	95	18	27	8	12	105	10	20	M16 x 50	80 x 80 x 8	10	A573+	10	MS	14	10	MS	14	14	X	X	X
Maximum Shoe Bolt Head Height	600	52	208	95	18	27	8	12	105	10	20	M16 x 50	80 x 80 x 8	12	A514*	12	MS	14	12	A514*	-4	-20	X	X	X
Maximum Shoe Tread Spike Height	600	52	208	95	18	27	8	12	105	10	20	M16 x 50	80 x 80 x 8	10	A573+	10	MS	14	10	MS	14	14	X	X	X
Shoe Grouser Web Height	700	52	208	95	18	27	8	12	105	10	20	M16 x 50	80 x 80 x 8	12	A514*	12	MS	14	12	A514*	-4	-20	X	X	X
Minimum Web to Underbody Clearance	700	52	208	95	18	27	8	12	105	10	20	M16 x 50	80 x 80 x 8	12	A514*	12	MS	14	12	A514*	-4	-20	X	X	X
Excavator Weight	800	52	208	95	18	27	8	12	105	10	20	M16 x 50	80 x 80 x 8	10	A573+	10	MS	14	10	MS	14	14	X	X	X
Clamp Bolts (2-off)	800	52	208	95	18	27	8	12	105	10	20	M16 x 50	80 x 80 x 8	10	A573+	10	MS	14	10	MS	14	14	X	X	X
Cleat Body Material	800	52	208	95	18	27	8	12	105	10	20	M16 x 50	80 x 80 x 8	12	A514*	12	MS	14	12	A514*	-4	-20	X	X	X
Grouser Edge Piece Material	800	52	208	95	18	27	8	12	105	10	20	M16 x 50	80 x 80 x 8	10	A573+	10	MS	14	10	MS	14	14	X	X	X
End Plate Material	800	52	208	95	18	27	8	12	105	10	20	M16 x 50	80 x 80 x 8	12	A514*	12	MS	14	12	A514*	-4	-20	X	X	X
Bolt Plate Type	800	52	208	95	18	27	8	12	105	10	20	M16 x 50	80 x 80 x 8	10	A514*	10	MS	14	10	MS	14	14	X	X	X
Clamp Plate Material	800	52	208	95	18	27	8	12	105	10	20	M16 x 50	80 x 80 x 8	12	A514*	12	MS	14	12	A514*	-4	-20	X	X	X
Minimum Operating Temperature	800	52	208	95	18	27	8	12	105	10	20	M16 x 50	80 x 80 x 8	10	A514*	10	MS	14	10	MS	14	14	X	X	X
Terrain Type	800	52	208	95	18	27	8	12	105	10	20	M16 x 50	80 x 80 x 8	12	A514*	12	MS	14	12	A514*	-4	-20	X	X	X
	800	52	208	95	18	27	8	12	105	10	20	M16 x 50	80 x 80 x 8	10	A514*	10	MS	14	10	MS	14	14	X	X	X
	800	52	208	95	18	27	8	12	105	10	20	M16 x 50	80 x 80 x 8	12	A514*	12	MS	14	12	A514*	-4	-20	X	X	X
	800	52	208	95	18	27	8	12	105	10	20	M16 x 50	80 x 80 x 8	10	A514*	10	MS	14	10	MS	14	14	X	X	X
	800	52	208	95	18	27	8	12	105	10	20	M16 x 50	80 x 80 x 8	12	A514*	12	MS	14	12	A514*	-4	-20	X	X	X
	800	52	208	95	18	27	8	12	105	10	20	M16 x 50	80 x 80 x 8	10	A514*	10	MS	14	10	MS	14	14	X	X	X
	800	52	208	95	18	27	8	12	105	10	20	M16 x 50	80 x 80 x 8	12	A514*	12	MS	14	12	A514*	-4	-20	X	X	X
	800	52	208	95	18	27	8	12	105	10	20	M16 x 50	80 x 80 x 8	10	A514*	10	MS	14	10	MS	14	14	X	X	X
	800	52	208	95	18	27	8	12	105	10	20	M16 x 50	80 x 80 x 8	12	A514*	12	MS	14	12	A514*	-4	-20	X	X	X
	800	52	208	95	18	27	8	12	105	10	20	M16 x 50	80 x 80 x 8	10	A514*	10	MS	14	10	MS	14	14	X	X	X
	800	52	208	95	18	27	8	12	105	10	20	M16 x 50	80 x 80 x 8	12	A514*	12	MS	14	12	A514*	-4	-20	X	X	X
	800	52	208	95	18	27	8	12	105	10	20	M16 x 50	80 x 80 x 8	10	A514*	10	MS	14	10	MS	14	14	X	X	X
	800	52	208	95	18	27	8	12	105	10	20	M16 x 50	80 x 80 x 8	12	A514*	12	MS	14	12	A514*	-4	-20	X	X	X
	800	52	208	95	18	27	8	12	105	10	20	M16 x 50	80 x 80 x 8	10	A514*	10	MS	14	10	MS	14	14	X	X	X
	800	52	208	95	18	27	8	12	105	10	20	M16 x 50	80 x 80 x 8	12	A514*	12	MS	14	12	A514*	-4	-20	X	X	X
	800	52	208	95	18	27	8	12	105	10	20	M16 x 50	80 x 80 x 8	10	A514*	10	MS	14	10	MS	14	14	X	X	X
	800	52	208	95	18	27	8	12	105	10	20	M16 x 50	80 x 80 x 8	12	A514*	12	MS	14	12	A514*	-4	-20	X	X	X
	800	52	208	95	18	27	8	12	105	10	20	M16 x 50	80 x 80 x 8	10	A514*	10	MS	14	10	MS	14	14	X	X	X
	800	52	208	95	18	27	8	12	105	10	20	M16 x 50	80 x 80 x 8	12	A514*	12	MS	14	12	A514*	-4	-20	X	X	X
	800	52	208	95	18	27	8	12	105	10	20	M16 x 50	80 x 80 x 8	10	A514*	10	MS	14	10	MS	14	14	X	X	X
	800	52	208	95	18	27	8	12	105	10	20	M16 x 50	80 x 80 x 8	12	A514*	12	MS	14	12	A514*	-4	-20	X	X	X
	800	52	208	95	18	27	8	12	105	10	20	M16 x 50	80 x 80 x 8	10	A514*	10	MS	14	10	MS	14	14	X	X	X
	800	52	208	95	18	27	8	12	105	10	20	M16 x 50	80 x 80 x 8	12	A514*	12	MS	14	12	A514*	-4	-20	X	X	X
	800	52	208	95	18	27	8	12	105	10	20	M16 x 50	80 x 80 x 8	10	A514*	10	MS	14	10	MS	14	14	X	X	X
	800	52	208	95	18	27	8	12	105	10	20	M16 x 50	80 x 80 x 8	12	A514*	12	MS	14	12	A514*	-4	-20	X	X	X
	800	52	208	95	18	27	8	12	105	10	20	M16 x 50	80 x 80 x 8	10	A514*	10	MS	14	10	MS	14	14	X	X	X
	800	52	208	95	18	27	8	12	105	10	20	M16 x 50	80 x 80 x 8	12	A514*	12	MS	14	12	A514*	-4	-20	X	X	X
	800	52	208	95	18	27	8	12	105	10	20	M16 x 50	80 x 80 x 8	10	A514*	10	MS	14	10	MS	14	14	X	X	X
	800	52	208	95	18	27	8	12	105	10	20	M16 x 50	80 x 80 x 8	12	A514*	12	MS	14	12	A514*	-4	-20	X	X	X
	800	52	208	95	18	27	8	12	105	10	20	M16 x 50	80 x 80 x 8	10	A514*	10	MS	14	10	MS	14	14	X	X	X
	800	52	208	95	18	27	8	12	105	10	20	M16 x 50	80 x 80 x 8	12	A514*	12	MS	14	12	A514*	-4	-20	X	X	X
	800	52	208	95	18	27	8	12	105	10	20	M16 x 50	80 x 80 x 8	10	A514*	10	MS	14	10	MS	14	14	X	X	X
	800	52	208	95	18	27	8	12	105	10	20	M16 x 50	80 x 80 x 8	12	A514*	12	MS	14	12	A514*	-4	-20	X	X	X
	800	52	208	95	18	27	8	12	105	10	20	M16 x 50	80 x 80 x 8	10	A514*	10	MS	14	10	MS	14	14	X	X	X
	800	52	208	95	18	27	8	12	105	10	20	M16 x 50	80 x 80 x 8	12	A514*	12	MS	14	12	A514*	-4	-20	X	X	X
	800	52	208	95	18	27	8	12	105	10	20	M16 x 50	80 x 80 x 8	10	A514*	10	MS	14	10	MS	14	14	X	X	X
	800	52	208	95	18	27	8	12	105	10	20	M16 x 50	80 x 80 x 8	12	A514*	12	MS	14	12	A514*	-4	-20	X	X	X
	800	52	208	95	18	27	8	12	105	10	20	M16 x 50	80 x 80 x 8	10	A514*	10	MS	14	10	MS	14	14	X	X	X
	800																								